

Avento Day-flex

22000 The Avento Day-flex is a chair that is electrically adjustable in height. Both the backrest, seat, and legrest can be freely adjusted electrically, allowing for a wide range of positions to optimally support the patient during treatments. The support with four castors and a central braking system provides the necessary mobility.

Support with high/low mechanism

- Firmly welded metal construction, standard with 2 cases for IV rods (Ø 19 mm).
- All corners and edges have been rounded.
- 4 Levina design castors Ø 125 mm with 2 directional castors at the front. The soft brake castors are centrally braked using design brake pedals. The brake pedals have a central position at both sides of the chair. The brake pedal can be reached when you stand in front of the chair.
- Stable high/low mechanism by means of equal supporting arms.
- The high/low adjustment between 50 and 80 cm (seat height) is possible by means of an intuitive handset.
- Extending, synthetic footrest with a step safety and with an antiskid structure.
- Thanks to the design synthetic cover cap, even the surfaces that are difficult to reach can be cleaned easily.

Seat

- Removable seat, made of a melamine coated MDF board of 12 mm.
- Upholstered with fire-retardant foam in 2 different density zones to guarantee an excellent seat comfort.
- The rounded front edge stimulates a fluent blood circulation.
- The upholstery is finished with decorative stitching.

Backrest and legrest

- Made of an ergonomically preformed plywood shell of 12 mm.
- Upholstered with fire-retardant foam in 2 different density zones to guarantee an excellent seat comfort.
- The backrest upholstery is finished with imitation leather and decorative stitching.
- Ergonomic push bar in synthetic material at the back.
- Made of a plywood board of 10 mm, upholstered with fire-retardant foam and completely upholstered.
- Optimal leg support during inclination thanks to the telescopic legrest.

Day-flex mechanism

- The backrest, seat, and legrest are separately adjustable by means of three actuators.
- In addition to individual adjustments, the chair can be quickly put in various pre-programmed positions:
 - Sitting position.
 - 'Zero gravity' (*) relax position.
 - Horizontal examination position.
 - Trendelenburg position for emergencies.
 - E-lift position to assist while getting up and sitting down.
- Furthermore, a personal preferred position can be saved for quick activation later.
- To prevent fall incidents, the electric functions cannot be activated if the brake is not engaged.
- Intuitive software prevents non-ergonomic positions during use.
- The controls are operated by means of a hand switch.

Lowerable armrests

- The ergonomic front design of the synthetic armrests makes it easy to stand up or sit down.
- Standard equipped with dinner tray attachments.
- Two solid epoxy-coated steel axes to adjust the height of the armrests in 3 different positions.
- Locked downwards by means of a spring lever.
- In their lowest position, the armrests are on the same level as the seat.

Colours

We would like to refer to our extensive colour gamut. Sample card + samples available on request.

Accessories

We would like to refer to our accessory list.

(*) Zero gravity position: this seat/lying position is based on NASA data. A neutral body position converts all muscle power into a biomedical balance. (Source: "From outer space to you", Omni, March 1994.)



Dimensions

22000 | Metal high/low relax chair:

- L 71 x D 84-182 x H 128-158 cm
- Seat height: 50 - 80 cm
- Seat depth: 52 cm
- Seat width: 53 cm
- Armrest height: 72 - 50 cm
- Safe working load: 200 kg

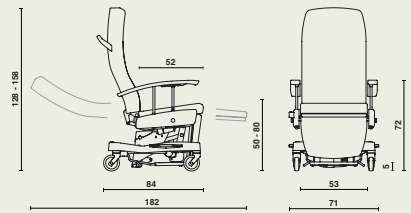

Materials and finishing

- Metal: epoxy coating (light grey).
- Wood: Plywood, MDF.
- Synthetic material.
- Fire-retardant foam.
- Upholstery: see collection.
- Resistant to the common cleaning products.

For further information about used **materials, constructions and maintenance**: please consult our material files.

Options

- Seat cushion with visco-elastic foam and a bi-elastic cover.
- Swivelling broadened armrests.
- Accessory brackets.
- Elice dinner tray.
- IV rod (1 or 2 sections).
- Dinner tray support on backrest.
- Li-Ion battery (4Ah).
- IV rod case Ø 32 mm on both sides.
- IV rod case Ø 32 mm on the right side (Ø 19 mm on left side).
- High/ low feet pedal.
- DIN rail.
- Upholstered arms.
- 4 twin castors Ø 125 mm with 2 directional castors at the front.
- Personal table, optionally with stainless steel tray.
- USB connector.

